

## Potential Alternative No. 1— Narrowed Harbor Drive (53'), with a 205' setback between B & Ash Streets and Grape & Hawthorne Streets.

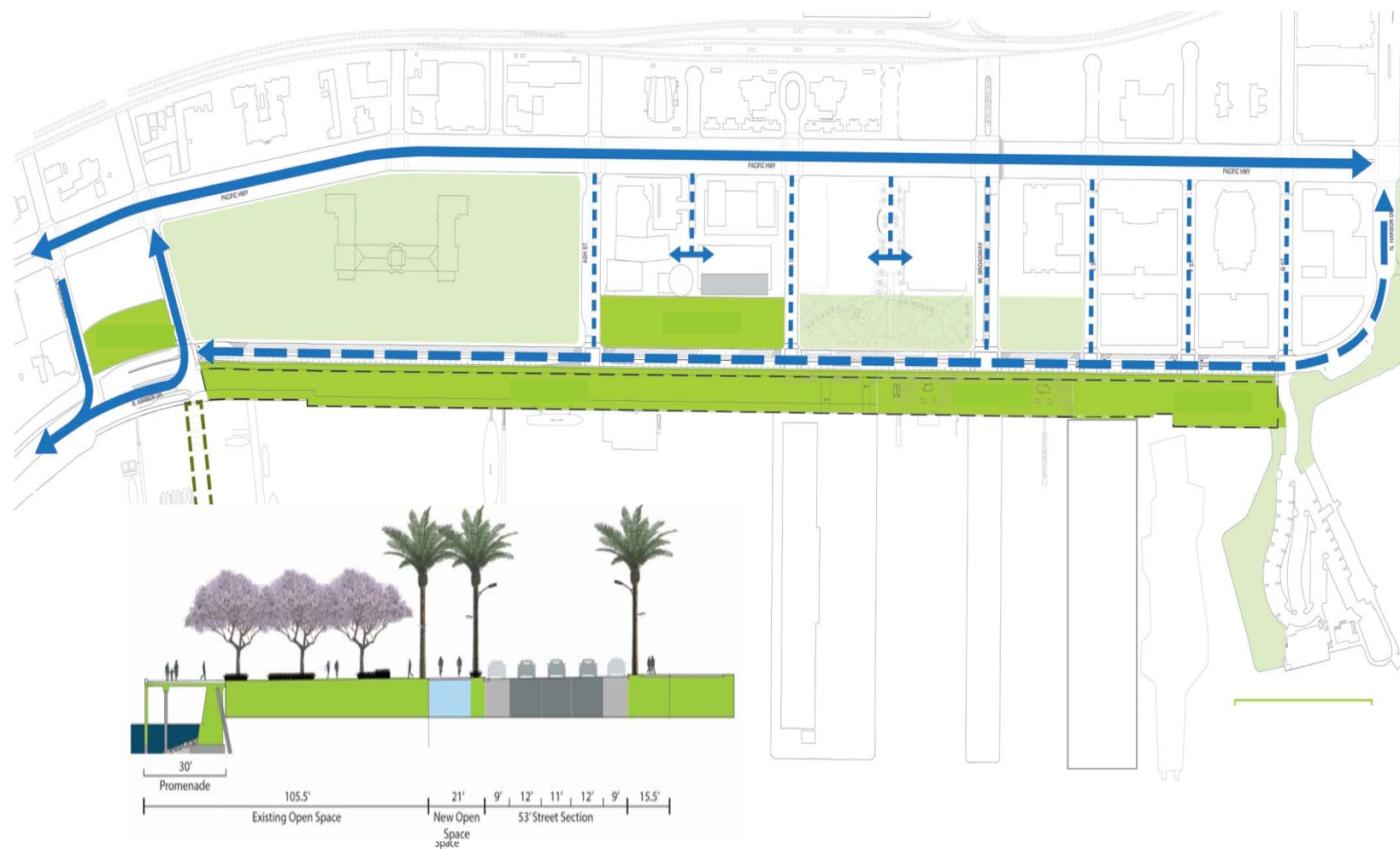

Potential Alternative No. 1 – Narrowed Harbor Drive (53') provides dedicated through traffic lane in North and South direction, a center turn lane, and provides parallel parking and loading zone on both sides of the street between G Street and Ash Street, and parallel parking and loading zones on the west side of Harbor Dr. and Diagonal parking on the east side of Harbor Drive between Ash and Grape Street.

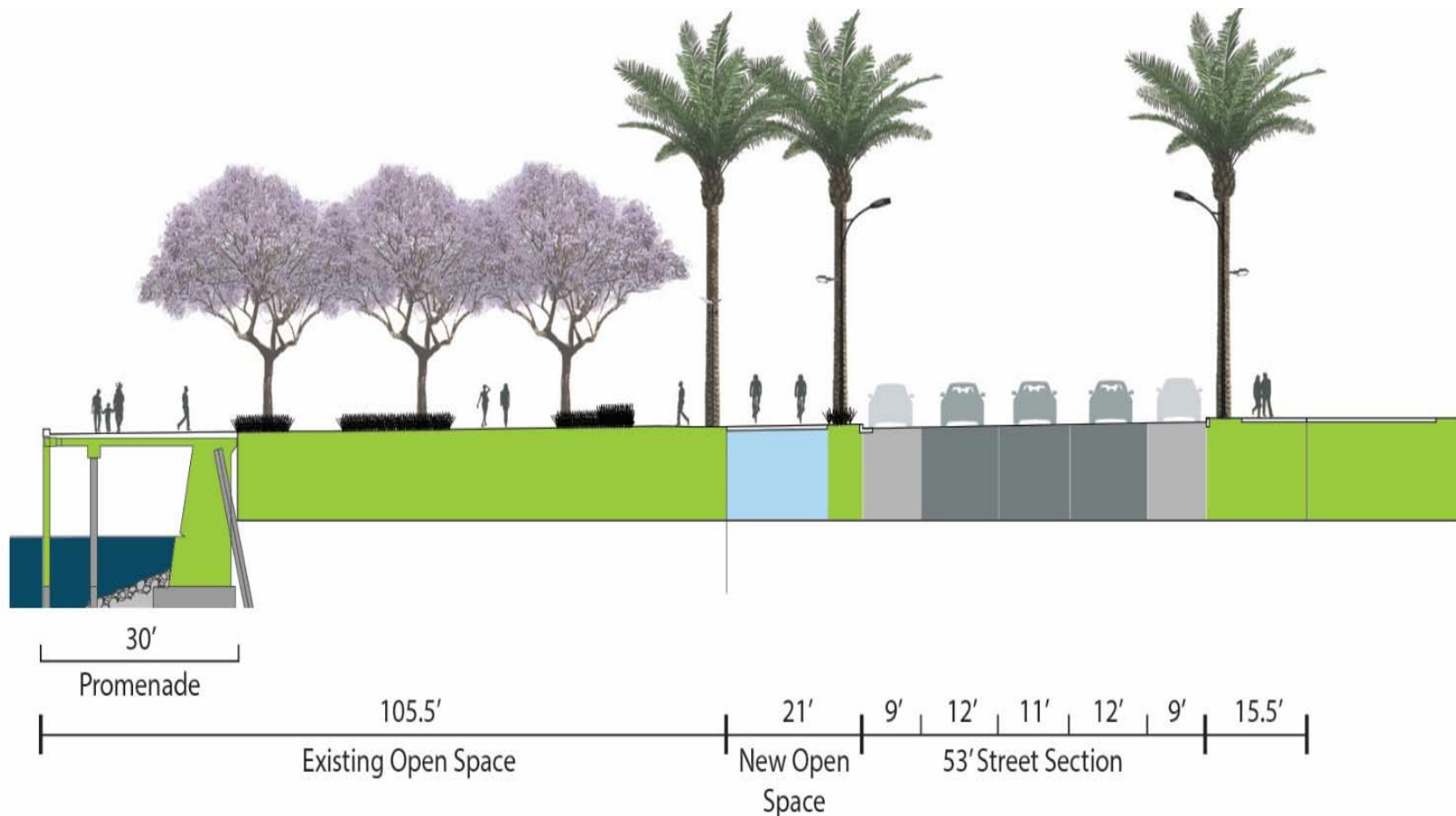

## Potential Alternative No. 2— Close Harbor Drive at County Waterfront park and narrow Harbor Drive (44') to the south (reducing its overall functionality)

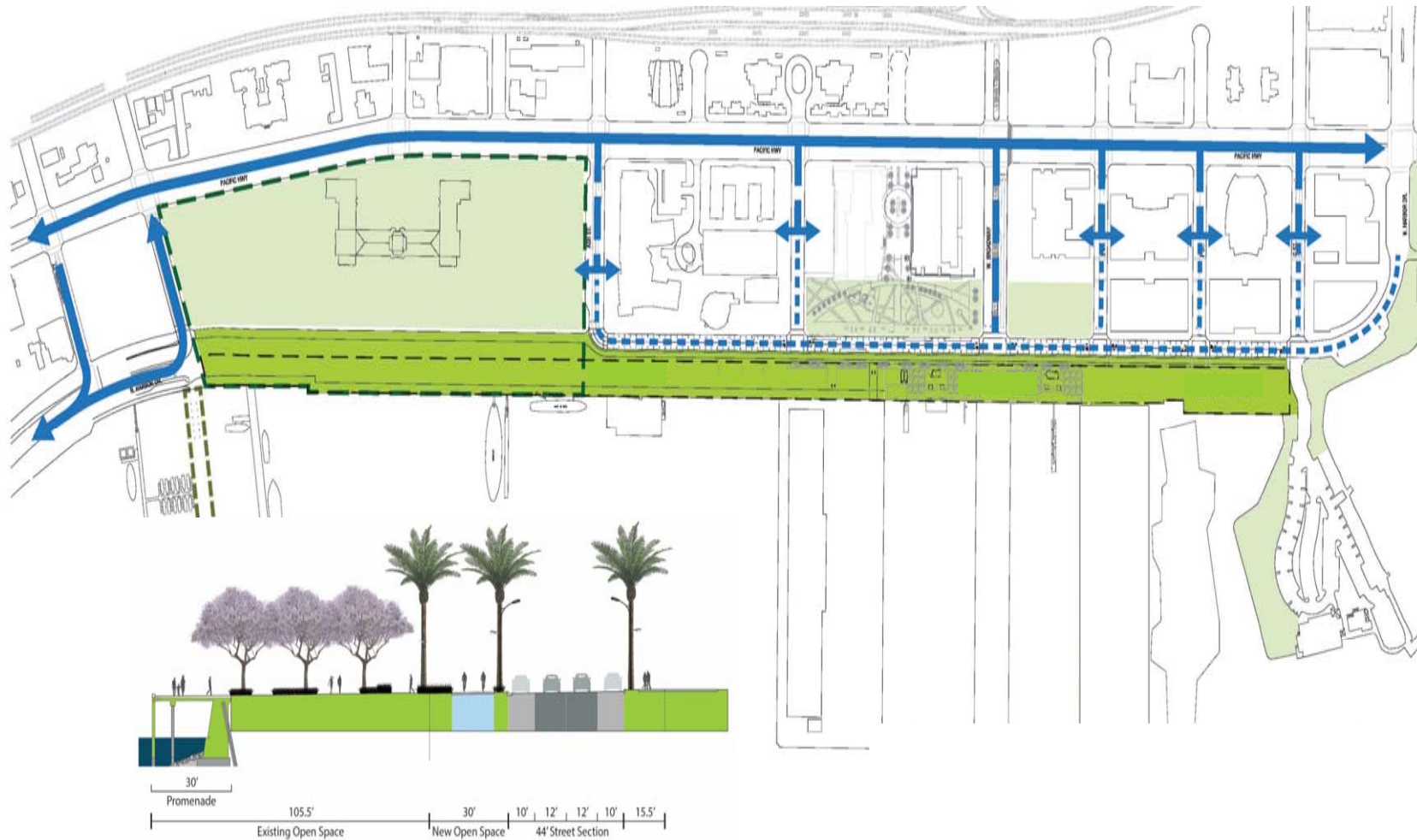

Potential Alternative No. 2 – Narrowed Harbor Drive (44') provides single lane of traffic in the north and south direction with parallel parking and loading zone on each side of the street. Proposed closure of Harbor Drive from Ash Street to Grape Street with a single lane adjacent to County Waterfront Park dedicated solely for emergency and service vehicles.

